

Safe-D U-Clip 30 For 25mm+ Trunkings



Suitable for direct to surface fitting

Safe-D U-Clip 30 fits perfectly in 30 x 15mm Mini Trunking, while the 23mm base can fit 25 x 16mm traditional trunking also.

Alternatively Safe-D 30's can be fixed directly to surfaces, with user-friendly and pliable tabs that simply fold-over to secure cables.

1st fix clips, then 2nd fix cables!

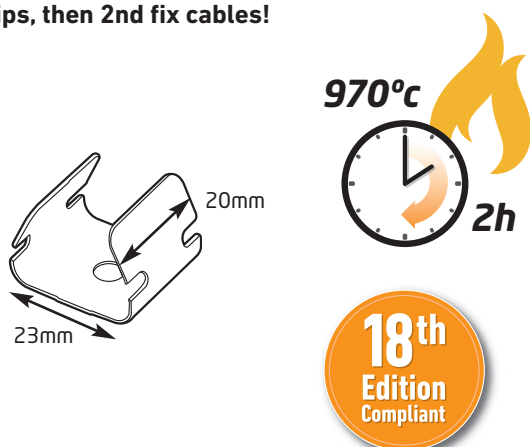

- Certified for 2 hours at 970°C
- Fully safety tested and certified to BS5839 part 1 compliant
- Thumb friendly, easy fold side-tabs
- Non-corrosive coating
- Ideal for ceiling voids, or popular PVC trunking
- Rounded edges for easy handling

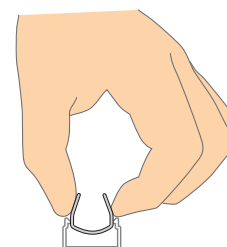
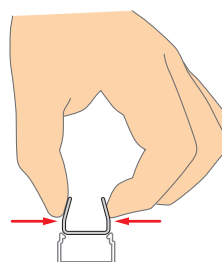

When inserting U-Clip 30 in 25x16mm trunkings, gently nipping the upright tabs causes the base to compress for tight fitment in the trunking.

Code	Description
SAFE-D30	(L) 20mm x (W) 23mm x (H) 8mm (folded) 5.7mm diameter pre-drilled hole in base

Safe-D 30 Fire Rated Clips *For 25mm+ Trunkings*

Product Specification

Produced from high temperature steel	<ul style="list-style-type: none">• Can withstand temperatures of up to 970°C for 2 hours• Safe-D Clips maintain strength after bending of side-tabs
U-shaped design	<ul style="list-style-type: none">• Easy to handle• Side-tabs fold-over to secure cables
Fold over rounded tabs	<ul style="list-style-type: none">• 20mm wide side-tabs & pliable gauge combine for quick and easy folding• Smooth & rounded edges, as required by design code BS7671 s522.8.11, to protect soft-skin cables etc (and user friendly!)
Pre-drilled hole in base (6mm diameter)	<ul style="list-style-type: none">• Accepts shot-fire or screw-fixed steel fixings (Select suitable fixing type according to substrate)
Passivated finish	<ul style="list-style-type: none">• Protects against corrosive elements
Fully tested & certified	<ul style="list-style-type: none">• Complies with requirements of BS5839 part 1 (2002 section 26.2d); BSEN50200:2000; & BS8434-1:2003
Weight	<ul style="list-style-type: none">• 3.9g Each 0.38kg Pack of 100